



Nivano CTe height adjustable changing table



**IMPORTANT
READ THIS
MANUAL
BEFORE USE**

User Manual and Installation Instructions

Guarantee

This product is guaranteed against all defects in
manufacture for a period of one year

This does not affect your statutory rights

Warranty Number:

Operating instructions Nivano height adjustable changing table

Product description.

The Nivano CTe is powered by a 230 Volt Mains supply internally reduced to 24Vdc And is provided with a backup battery.

The changing table is intended for showering and changing children and adults, weighing up to 135Kg Standard version and 200Kg uprated version, the changing table must not be used for any other purpose.

Carry out the following checks daily; before using the changing table.

Check the weight of the client and ensure the machine is rated for the weight to be lifted

Check the mains supply is connected and turned on..

Check there are no obstructions or items that may be trapped when the changing table is operated.

Check the changing table will raise and lower properly using the handset.

Check the function of the bed retaining catch.

Fig 1

Instructions for use.

Before use check that the changing table will lift and lower using the handset. (FIG 1)

Adjusting the height of your changing table

The changing table is operated with a two-button handset. Pressing one of the buttons will either raise or lower the changing table as required.

Position the table at a convenient height to transfer the client.

Using the platform

To release the changing platform push down the green (Fig 2) latch on the right hand side of the platform. Once the latch is released, rotate the platform forward into a horizontal position. To stow the platform simply rotate the bed upwards until the bed is parallel with the cover, the latch will engage and will stop the bed from falling forward.

Caution

The heavy use of oil based products may adversely affect the white stretcher material. Oils and other petrochemical products should be avoided and any residue removed immediately.

These products include : Baby oil and emollient creams,

Cleaning

The changing table may be cleaned using most mild cleaning agents.

Chemical agents and solvents must not be used, i.e. drain cleaners, acetone, oven cleaners or acids.

The changing table should be cleaned using a warm soapy solution and rinsed off, then dried with a soft cloth.

Attention should always be paid to instruction labels for the cleaning agent.

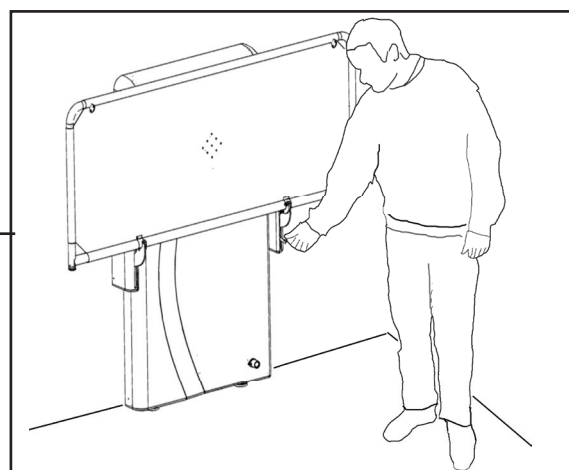
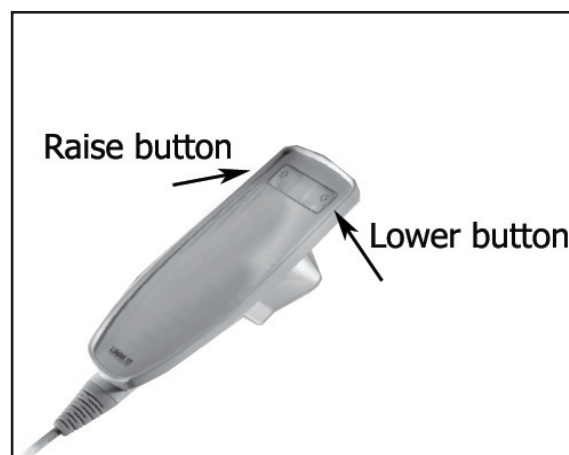
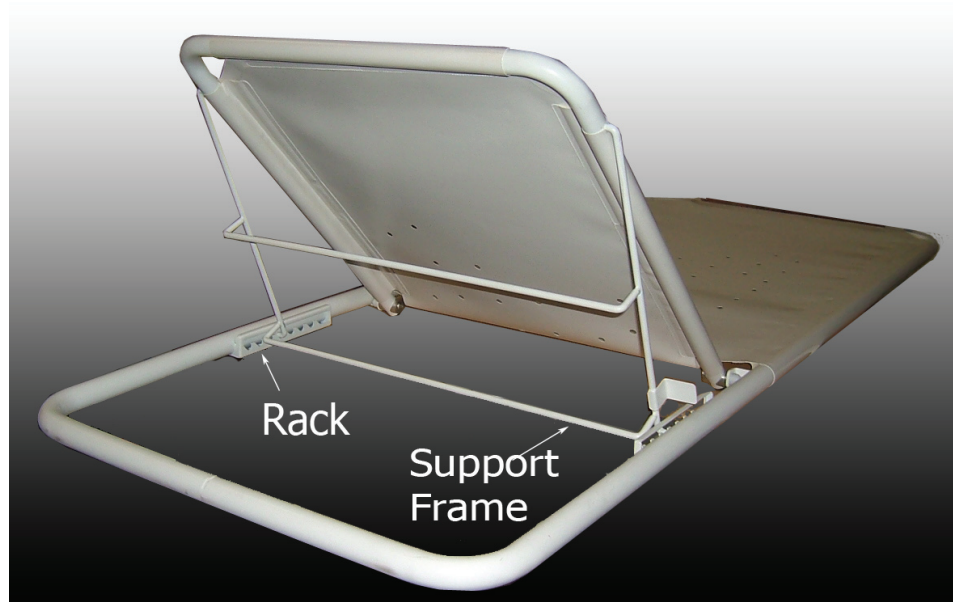

Fig 2

Using the HT Vinyl bed with back rest.

Before transferring the patient to the bed, preset the back rest to the desired position, by lifting the back rest to the desired height and locating the support into the retaining rack, ensure the bar is secure and will not slip when the patient leans against the back rest.

If adjustments are required the patient should sit forward and not lean on the back rest as it is adjusted.



Operation of the padded bed back rest

Before transferring the patient to the bed, preset the back rest to the desired position, by turning the operating handle and raising the back rest against the pressure of your hand.

Small adjustments may be made with the patient in position, always ensure the patient is sufficiently supported before making any adjustments.

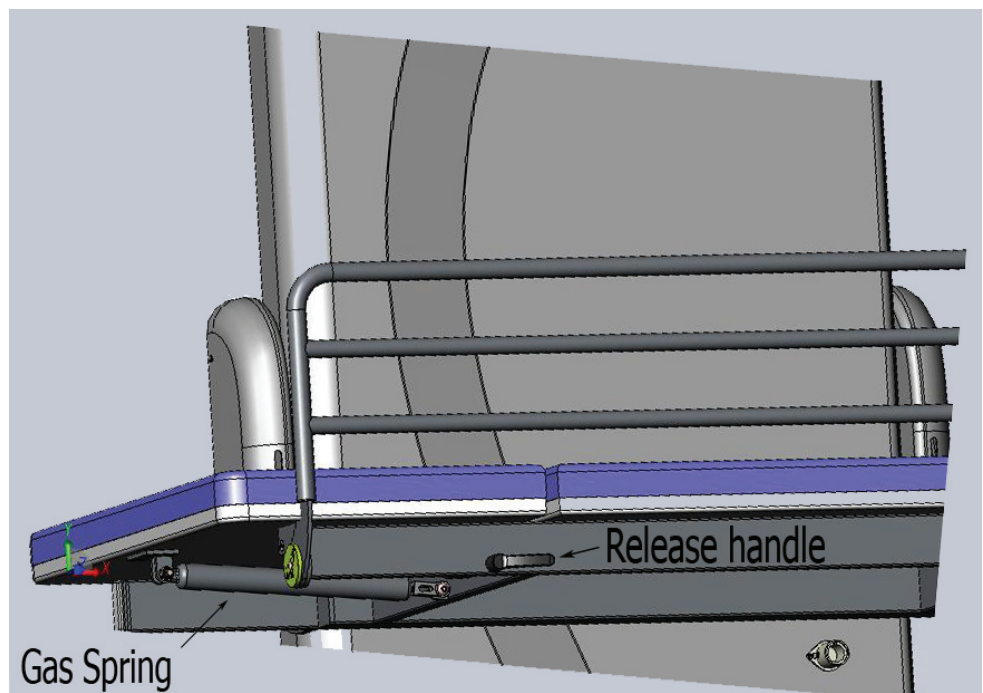

Operating the guard (where fitted)

Folding the guard

Lift the guard upwards

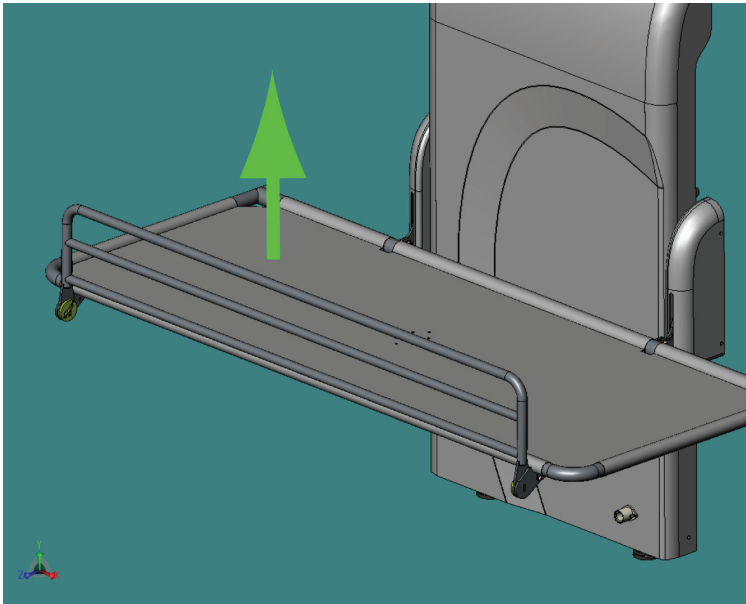

Then rotate it towards
you and then fold
under the bed.

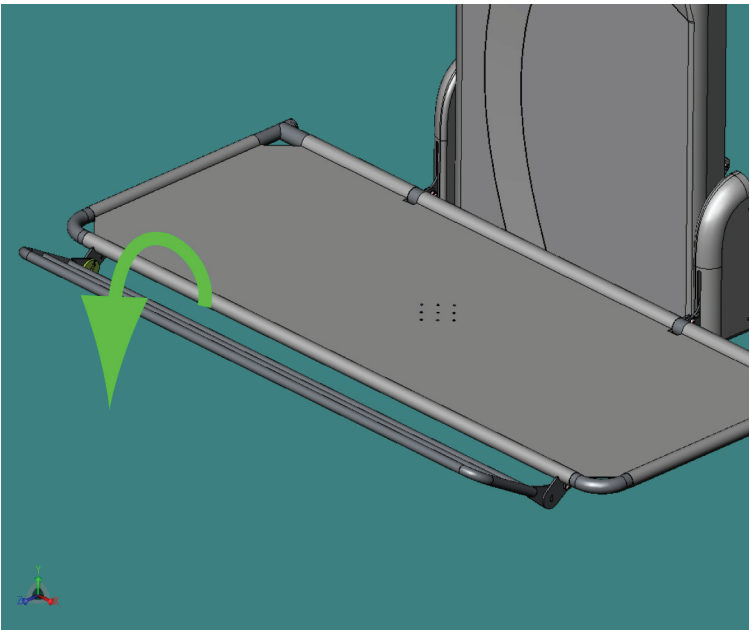

It will then lock under
the bed.

To replace the guard
lift it slightly towards
you, it will then
release, rotate upright
and drop into position

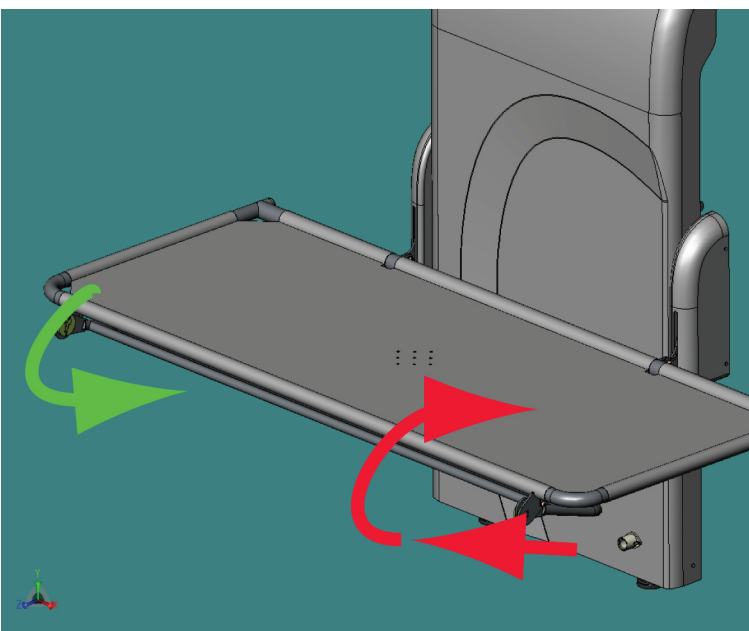

Installation

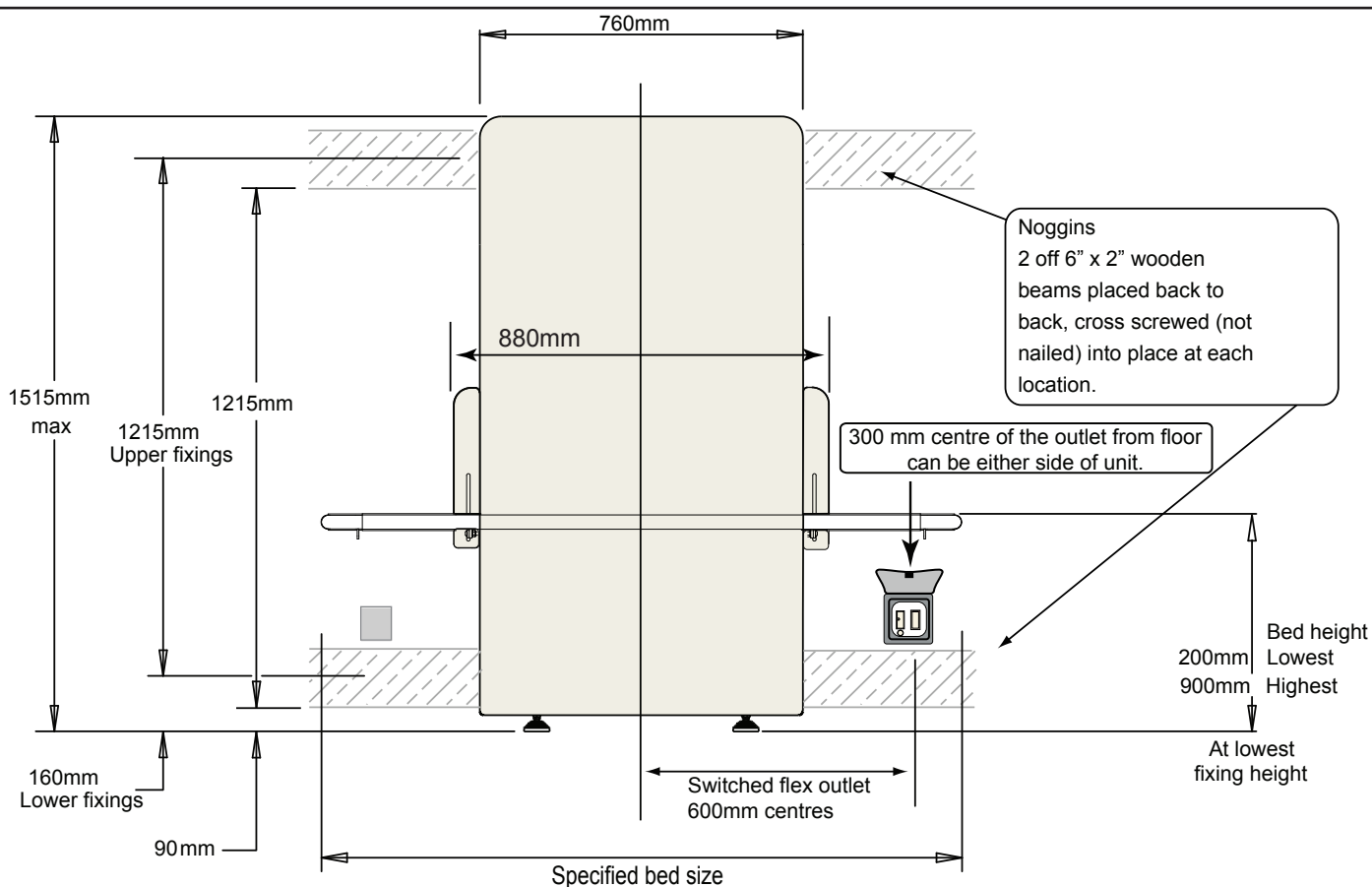

Electrical.

The Nivano is supplied with mains electric (230v) and transformed to 24v within the unit. A protected mains circuit is required. A flush mounted fused spur with flex outlet cover is required on the wall next to the unit. (In wet areas a waterproof, MK. Masterseal 56410 WHI or similar is recommended)

Fixing.

The Nivano is fixed to the wall but also rests on the floor. The wall to which it is fitted should be load bearing (i.e. strong enough to carry a 100 Kg load on each wall fixing), flat and free from obstruction from floor level to 1550mm above the floor and a minimum of 50mm wider than the specified bed size. If the Nivano needs to be fitted to a stud wall, the wall will need special reinforcement; either noggins as shown above; or 25mm (1 inch) marine or exterior plywood, secured every 200mm, should be used to cover the area behind the unit and extend 100mm either side of the unit. The plywood support must be in contact with, and supported by the floor

Installation Instructions.

Please Note: Due to the complexity of different building methods Astor Bannerman do not supply installation fixings and anchors.

Installing the main frame.

- Place the rise and fall unit against the wall in the required position, adjust the feet to level the unit at the required height and secure the foot locking nuts.
N. B. The height of the feet affects the final position to which the bed will raise or lower.
- Ensure the moving framework will clear the power outlet.
- Mark through the four fixing points in the frame, move the frame to one side.
- For fixing into masonry, drill four holes pilot holes 6 mm and open up to accept your Anchor fittings.
- Fix the unit securely to the wall using suitable fixings.
- Connect the handset to the socket in the base of the lift actuator and connect the backup battery. The power supply cable to the mains outlet can now be connected.
- Test the unit throughout its entire lifting range, ensure it does not foul the wall or any other fittings.
- To limit the height at which the bed stops during its downward travel a stop collar is available. Contact Astor Bannerman for details

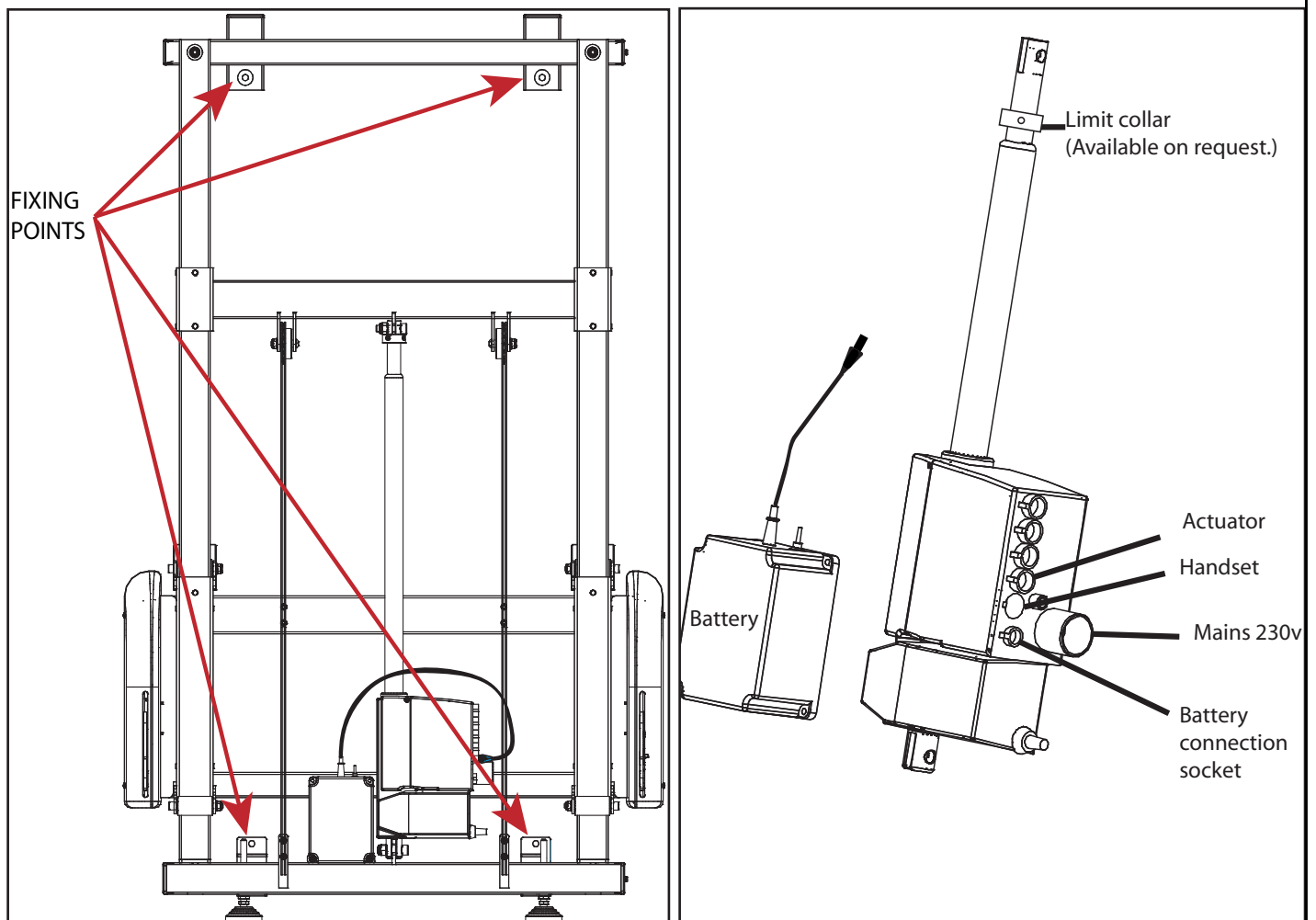

- Disconnect the handset from the actuator and fit the extension lead from the cover into the handset socket, then position the main cover to fit neatly over the plastic bungs in the sides of the frame.
- Drill four 4mm holes into the plastic bungs in the frame ends through the existing cover holes, in order to fit the plastic rivets that retain the cover.
- Locate the rivet bodies in the holes, then push each of the mushroom portions of the white plastic rivets into the rivet body. This will require a firm push, the mushroom is fully seated once the base of the mushroom head is flush with the cover.

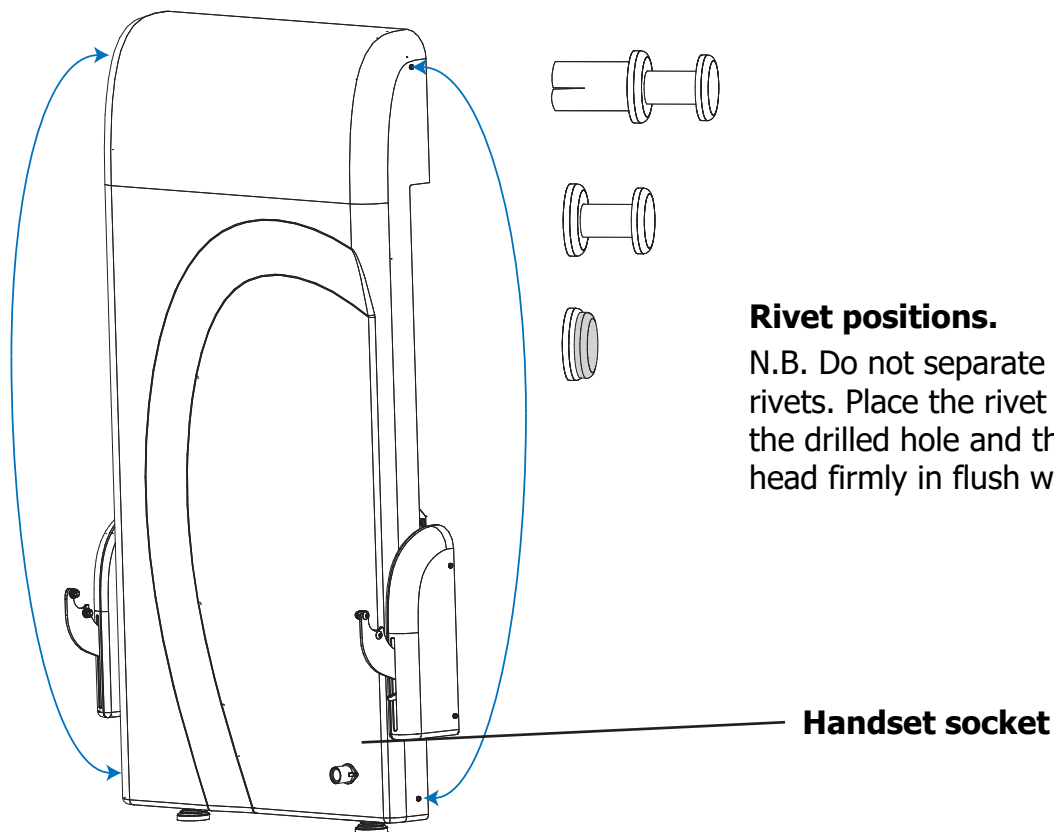

- Connect the handset to the socket on the main cover, lubricate the O ring with silicon to aid assembly.
- Discuss the positioning of the handset holder with the client and fit the handset holder in a convenient position for the user.

Ensure the Handset cable is routed so that it cannot become trapped when in use.

Repeat the process to fit the 2 side covers before fitting the bed

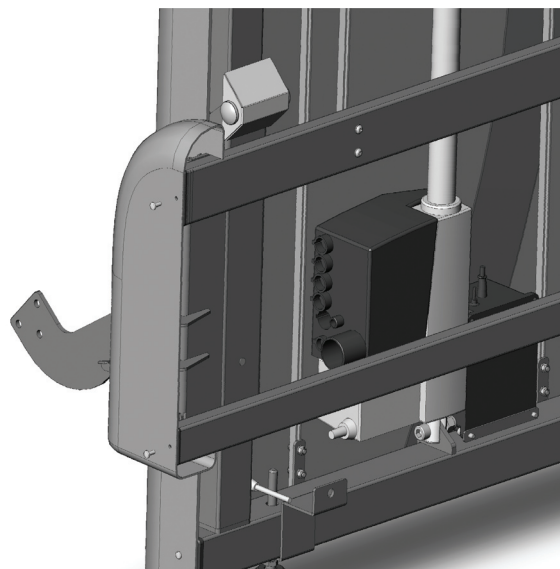
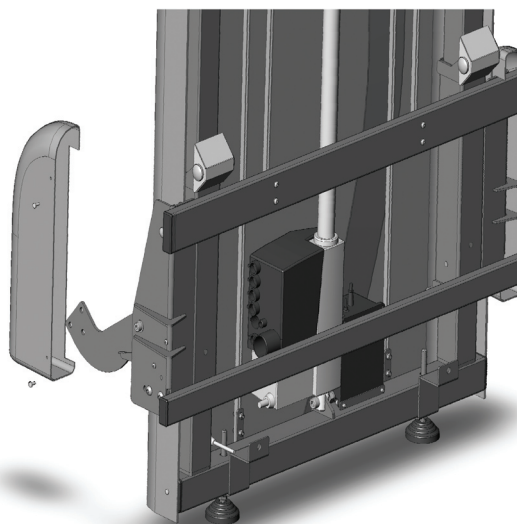

Fitting the Bed.

- The bed is fitted in the vertical (stowed) position.
- Unpack the bed and locate the fixing screws.
- Lift the bed into position with the top facing the wall and the guard, if fitted, folded under the bed. Ensure the mounting brackets on the bed are inside the arms on the frame.
- Align the holes and fit the securing bolts. (4 x M8 domed head Allen screws)

To lower the bed, lift the bed and depress the green lever on the right of the unit, lower the bed to the horizontal position.

- Raise the bed and check that the lock lever engages and retains the bed in the upright position.
- Check the guard rail operates correctly. (If fitted)
- Lower the bed, protect the covering and using calibrated weights, **Load test the installation to the safe working load** through out the whole lifting range.



Packing list

#	Item No.	Item Description	Quantity
1	20.039.00.0004	Handset, black, 2 button, 8 pin din	1
2	21.090.00.0187	Screw, M8x25, stainless hex socket dome head	4
3	21.090.00.0416	Nut, M8 Stainless steel nyloc	4
4	20.032.00.0003	Holder, handset	1
5	21.090.00.0059	Washer, M8 stainless steel	4
6	21.090.00.0360	Sucker pad, for handset holder	1

Major items

Machine spine
Front cover
2 side covers
1 Bed

Technical Specification.

Maximum patient weight: 135Kg standard Version. 200 Kg uprated version.

Duty cycle: 10%, Maximum 2 min/18 min

IP Rating: IP X4

Supply voltage: 110V or 230V ac

Power 1.25KW

Dry weights:

Lifting spine 38.5 kG.

1700mm high tension stretcher 18.5 Kg

1700mm high tension stretcher with back rest and guard 20.2 Kg

1700mm Padded bed 32.5 Kg

A weighted sound emission <70dB(A)



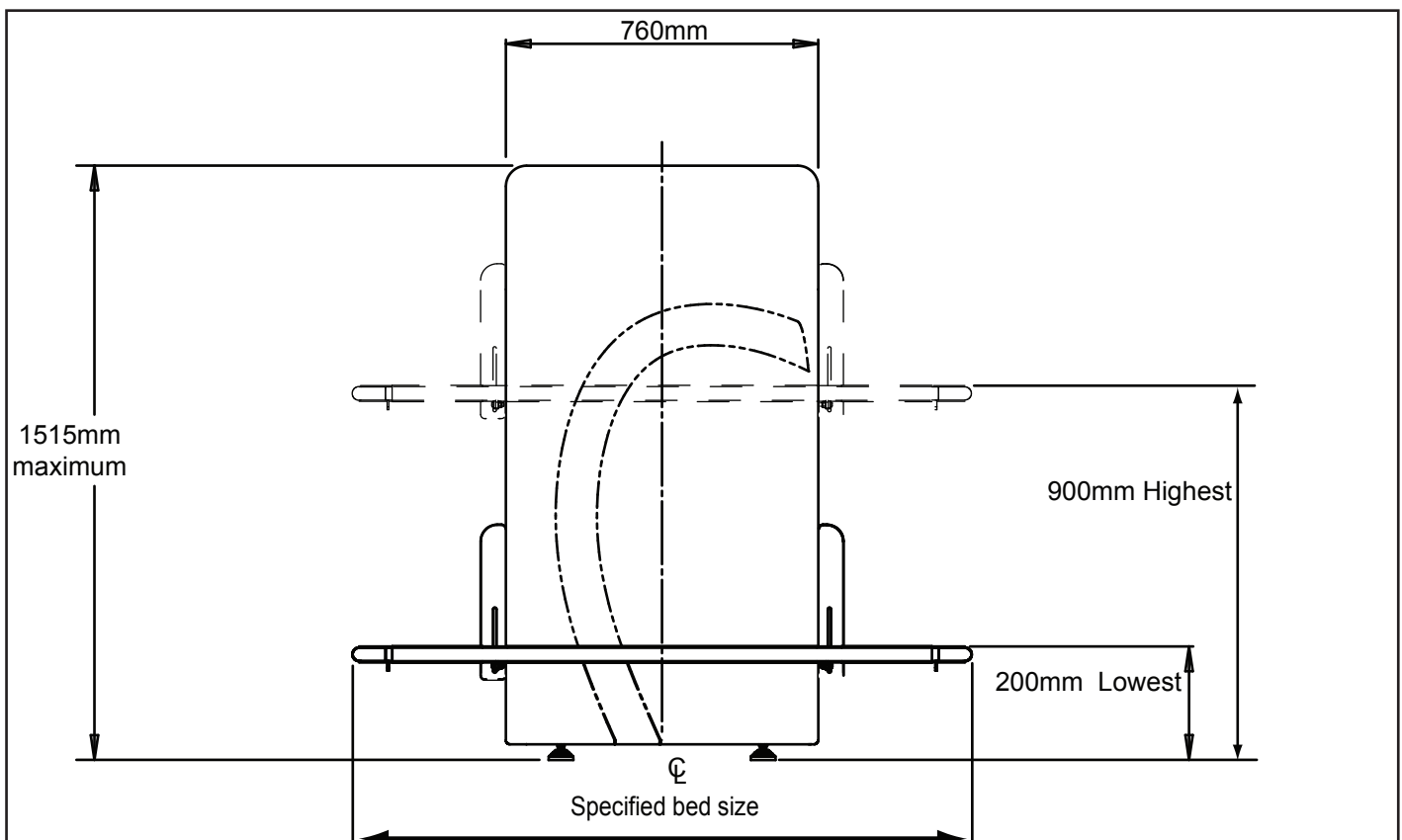



The changing table is intended for showering and changing children and adults, weighing up to 135 KG, the changing table must not be used for any other purpose.









Preventative maintenance.

Carry out the following checks:	Daily	Weekly	6 Monthly	Annually
Full function test of the equipment.	✓	✓	✓	✓
Check security of wall fixings			✓	✓
Check electrical safety				✓
Carry out load test to 1 x SWL				
Stretcher / Bed				
Check the condition of the stretcher covering	✓	✓	✓	✓
Check the security and function of locking catch	✓	✓	✓	✓
Examine the optional guard for correct fitting and security	✓	✓	✓	✓
Examine the stretcher for wear or damage.			✓	✓
Check the stretcher is securely attached		✓	✓	✓

Product Labels

Model: NIVANO CTe <div>  </div>		
Lift range: 700 mm SWL 200 Kg		
230V ~ 50Hz 250W IP X4		
	Read Instructions before use 	 2014
	Pb	
Made in England by: Astor Bannerman (Medical) Limited 11f Coln Park industrial estate Andoversford GL54 4HJ		

Model: NIVANO CTe <div>  </div>		
Lift range: 700 mm SWL 135 Kg		
240V ac 250 VA IP X4		
	Read Instructions before use 	 2011
	Pb	
Made in England by: Astor Bannerman (Medical) Limited 11f Coln Park industrial estate Andoversford GL54 4HJ		



Unit 11F, Coln Park Industrial Estate
Andoversford
Cheltenham
Gloucestershire, GL54 4HJ
Tel.: 01242-820820
Fax: 01242-821110
email: sales@astorbannerman.co.uk